

Sea Star

A sculpture by Bathsheba Grossman
www.bathsheba.com © 2003

You'll need:

- * the 20 wooden pieces
- * toothpicks
- * rubber bands
- * wood glue (Elmer's works well)
- * a safe place for working with glue

Put it together in one sitting!

If you let the glue dry between steps, the modules may not fit together. Wood glue usually takes about an hour to set, which is plenty of time to finish the job.

Making Glue Joints →

Put a small drop of glue in place with a toothpick, then slide the slots into place.

If a joint fits loosely, wrap a rubber band around it.

When the slots are fully engaged, tiny drops of glue will come out at the sides. The corner of a bit of folded paper works well to wipe them off.

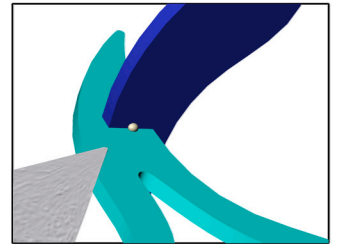
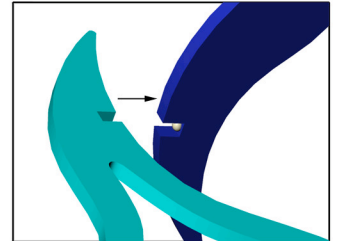
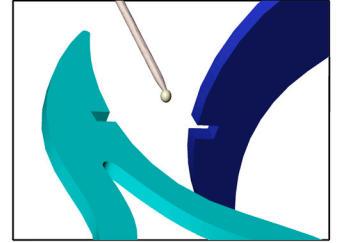

A

Connector (12)

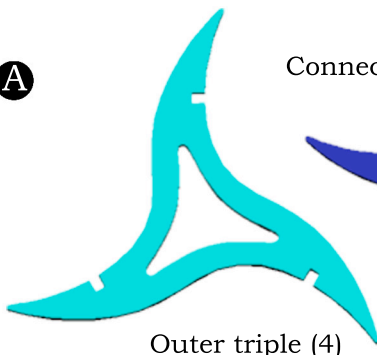

Outer triple (4)

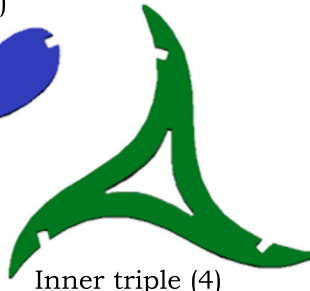

Inner triple (4)

B

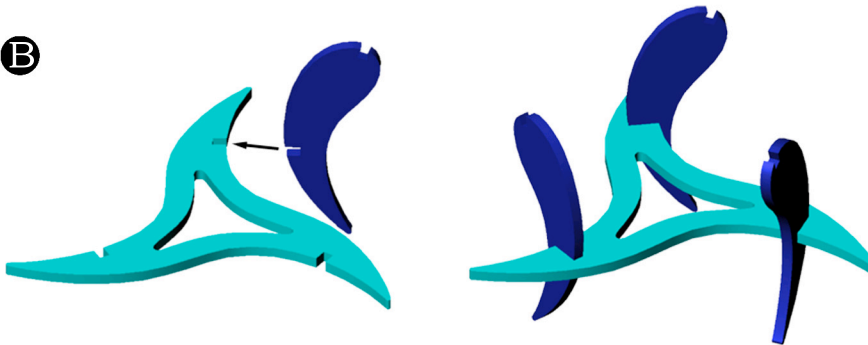

Add three connectors to each outer triple.

Make sure they rotate in the same direction, either all clockwise or all counterclockwise.

C

Choose one assembly, and add three inner triples onto its connectors.

